

# TEMPORARY TRAFFIC CONTROL TYPICAL APPLICATION FOR SIDEWALK CLOSURE ALTERNATE PEDESTRIAN ROUTE USING ROADWAY LANE OR SHOULDER

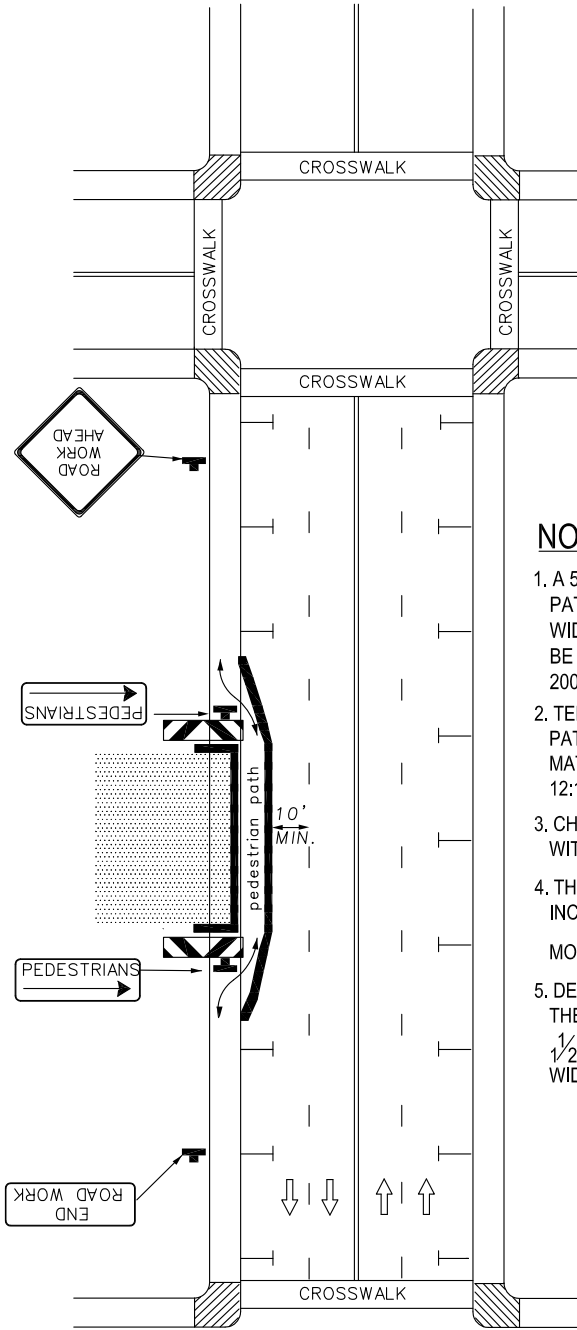









**IMPORTANT:**  
THIS DRAWING SHALL BE USED IN  
COMBINATION WITH THE GENERAL  
NOTES BC 104.01-1 THRU BC 104.01-7

## NOTES

1. A 5 FOOT MINIMUM WIDTH PEDESTRIAN PATH / ALTERNATE PEDESTRIAN PATH SHALL BE MAINTAINED WHERE POSSIBLE. WHERE A 5 FOOT MIN WIDTH CANNOT BE ACHIEVED, A MINIMUM WIDTH OF 36 INCHES SHALL BE PROVIDED WITH PASSING ZONES (60 IN X 60 IN) AT LEAST EVERY 200FT.
2. TEMPORARY RAMPS SHALL HAVE A SLOPE OF 12:1 MAX. THE PEDESTRIAN PATH AND RAMP SHALL BE CONSTRUCTED OF HOT MIX ASPHALT OR OTHER MATERIAL THAT CAN PROVIDE SMOOTH, HARD SURFACE & WILL MAINTAIN 12:1 SLOPE.
3. CHANNELIZING DEVICES SHALL BE TEMPORARY CONCRETE BARRIERS WITH THE ADDITION OF CONTINUOUS DETECTABLE EDGING.
4. THE CONTINUOUS DETECTABLE EDGINGS SHALL PROTRUDE AT LEAST 6 INCHES ABOVE THE PATHWAY WITH THE BOTTOM OF THE EDGING NO MORE THAN 1/2 INCHES ABOVE THE PATHWAY.
5. DETECTABLE BARRICADES SHALL EXTEND AT LEAST 36" ABOVE THE PATHWAY WITH THE BOTTOM OF THE BARRICADE NO MORE THAN 1/2 INCHES ABOVE THE PATHWAY, AND SHALL EXTEND THE FULL WIDTH OF THE CLOSURE

### KEY:

-  SIGN
-  CHANNELIZING DEVICES WITH DETECTABLE EDGING
-  DETECTABLE BARRICADE
-  DIRECTION OF TRAFFIC
-  WORK SITE
-  PARKING SPACES / SHOULDER AREA
-  TEMPORARY RAMP (WITH DETECTABLE SURFACE WARNING)
-  EXISTING CURB RAMP



APPROVED:  
*Frank Murphy*  
DEPUTY DIRECTOR - OPERATIONS  
*Khalil Zayed*  
DIRECTOR, DEPARTMENT OF TRANSPORTATION

**CITY OF BALTIMORE  
DEPARTMENT OF TRANSPORTATION  
TRAFFIC DIVISION**

**PED AND CURB-LANE CONTROL /  
MULTILANE UNDIVIDED SPEEDS  
LESS THAN OR EQUAL TO 40 MPH /  
OVER 12 HRS. OR NIGHTTIME USE**

ISSUED	REVISED	REVISED	
8 / 2010			
<b>STANDARD NO. BC 117.01-1</b>			
SCALE: NONE		SHEET 1 OF 4	